



UNITED
A PUPCO BRAND



FLANGED FITTINGS CATALOG

www.UnitedWaterProducts.com | (401) 250-3800

Flanged Fittings



DESCRIPTION

2"-24" Flanged Fittings in elbows, tees, crosses, laterals, reducers, and blind flanges.

ADDITIONAL INFO

- Faced and drilled in accordance with ANSI B16.1 Class 125/ANSI B16.5 Class 150 or Class 250.
- 250 WWP
- Made from Ductile Cast Iron, ASTM A536
- Unlined
- Additional sizes available on request



DESCRIPTION

2"-24" Flanged Fittings in elbows, tees, crosses, laterals, reducers, and blind flanges.

ADDITIONAL INFO

- Faced and drilled in accordance with ANSI B16.1 Class 125/ANSI B16.5 Class 150 or Class 250.
- 250 WWP
- Made from Ductile Cast Iron, ASTM A536
- Standard lining of cement mortar with bitumen overlay (NSF 61) in accordance with AWWA C104, ANSI A21.4 and a standard coating of a red color, zinc rich primer.
- Additional sizes available on request

Flanged Elbows			
PART #		SIZE	BEND (DEGREES)
UNLINED	CEMENT-LINED		
10F-0202	W10F-0202-D	2"	90°
10F-025025	W10F-025025-D	2½"	90°
10F-0302	W10F-0302-D	3 × 2"	90°
10F-03025	W10F-03025-D	3 × 2½"	90°
10F-0303	W10F-0303-D	3"	90°
10F-0402	W10F-0402-D	4 × 2"	90°
10F-04025	W10F-04025-D	4 × 2½"	90°
10F-0403	W10F-0403-D	4 × 3"	90°
10F-0404	W10F-0404-D	4"	90°
10F-0503	—	5 × 3"	90°

Flanged Elbows (Cont.)			
PART #		SIZE	BEND (DEGREES)
UNLINED	CEMENT-LINED		
10F-0504	W10F-0504-D	5 × 4"	90°
10F-0505	W10F-0505-D	5"	90°
10F-0603	W10F-0603-D	6 × 3"	90°
10F-0604	W10F-0604-D	6 × 4"	90°
10F-0605	W10F-0605-D	6 × 5"	90°
10F-0606	W10F-0606-D	6"	90°
10F-0804	W10F-0804-D	8 × 4"	90°
10F-0805	W10F-0805-D	8 × 5"	90°
10F-0806	W10F-0806-D	8 × 6"	90°
10F-0808	W10F-0808-D	8"	90°

Flanged Elbows (Cont.)			
PART #		SIZE	BEND (DEGREES)
UNLINED	CEMENT-LINED		
10F-1004	W10F-1004-D	10 × 4"	90°
10F-1006	W10F-1006-D	10 × 6"	90°
10F-1008	W10F-1008-D	10 × 8"	90°
10F-1010	W10F-1010-D	10"	90°
10F-1204	W10F-1204-D	12 × 4"	90°
10F-1206	W10F-1206-D	12 × 6"	90°
10F-1208	W10F-1208-D	12 × 8"	90°
10F-1210	W10F-1210-D	12 × 10"	90°
10F-1212	W10F-1212-D	12"	90°
10F-1410	W10F-1410-D	14 × 10"	90°
10F-1412	W10F-1412-D	14 × 12"	90°
10F-1414	W10F-1414-D	14"	90°
10F-1610	W10F-1610-D	16 × 10"	90°
10F-1612	W10F-1612-D	16 × 12"	90°
10F-1614	W10F-1614-D	16 × 14"	90°
10F-1616	W10F-1616-D	16"	90°
10F-1818	W10F-1818-D	18"	90°
10F-2020	W10F-2020-D	20"	90°
10F-2424	W10F-2424-D	24"	90°
11F-0202	W11F-0202-D	2"	45°
11F-025025	W11F-025025-D	2½"	45°
11F-0303	W11F-0303-D	3"	45°
11F-0404	W11F-0404-D	4"	45°
11F-0505	W11F-0505-D	5"	45°
11F-0606	W11F-0606-D	6"	45°
11F-0808	W11F-0808-D	8"	45°
11F-1010	W11F-1010-D	10"	45°
11F-1212	W11F-1212-D	12"	45°
11F-1414	W11F-1414-D	14"	45°
11F-1616	W11F-1616-D	16"	45°
12F-0303	W12F-0303-D	3"	22½°
12F-0404	W12F-0404-D	4"	22½°
12F-0606	W12F-0606-D	6"	22½°
12F-0808	W12F-0808-D	8"	22½°

Flanged Elbows (Cont.)			
PART #		SIZE	BEND (DEGREES)
UNLINED	CEMENT-LINED		
12F-1010	W12F-1010-D	10"	22½°
12F-1212	W12F-1212-D	12"	22½°
13F-0303	W13F-0303-D	3"	11¼°
13F-0404	W13F-0404-D	4"	11¼°
13F-0606	W13F-0606-D	6"	11¼°
13F-0808	W13F-0808-D	8"	11¼°
13F-1010	W13F-1010-D	10"	11¼°
13F-1212	W13F-1212-D	12"	11¼°

Flanged Long Radius Elbows			
PART #		SIZE	BEND (DEGREES)
UNLINED	CEMENT-LINED		
15F-0202	—	2"	90°
15F-025025	—	2½"	90°
15F-0303	W15F-0303-D	3"	90°
15F-0403	W15F-0403-D	4 × 3"	90°
15F-0404	W15F-0404-D	4"	90°
15F-0604	W15F-0604-D	6 × 4"	90°
15F-0606	W15F-0606-D	6"	90°
15F-0806	W15F-0806-D	8 × 6"	90°
15F-0808	W15F-0808-D	8"	90°
15F-1010	W15F-1010-D	10"	90°
15F-1212	W15F-1212-D	12"	90°

Flanged Base Elbows			
PART #		SIZE	BEND (DEGREES)
UNLINED	CEMENT-LINED		
16F-0303	W16F-0303-D	3"	90°
16F-0404	W16F-0404-D	4"	90°
16F-0606	W16F-0606-D	6"	90°
16F-0808	W16F-0808-D	8"	90°
16F-1010	W16F-1010-D	10"	90°
16F-1212	W16F-1212-D	12"	90°
16F-1414	W16F-1414-D	14"	90°
16F-1616	W16F-1616-D	16"	90°

Flanged Side Outlet Elbows			
PART #		SIZE	BEND (DEGREES)
UNLINED	CEMENT-LINED		
18F-0404	W18F-0404-D	4"	90°
18F-0606	W18F-0606-D	6"	90°
18F-0808	W18F-0808-D	8"	90°
18F-1010	W18F-1010-D	10"	90°
18F-1212	W18F-1212-D	12"	90°
18F-1414	W18F-1414-D	14"	90°
18F-1616	W18F-1616-D	16"	90°

Flanged Base Tees		
PART #		SIZE
UNLINED	CEMENT-LINED	
17F-0303	W17F-0303-D	3"
17F-0404	W17F-0404-D	4"
17F-0606	W17F-0606-D	6"
17F-0808	W17F-0808-D	8"
17F-1010	W17F-1010-D	10"
17F-1212	W17F-1212-D	12"

Flanged Side Outlet Tees		
PART #		SIZE
UNLINED	CEMENT-LINED	
19F-0303	W19F-0303-D	3"
19F-0404	W19F-0404-D	4"
19F-0606	W19F-0606-D	6"
19F-0808	W19F-0808-D	8"
19F-1010	W19F-1010-D	10"
19F-1212	W19F-1212-D	12"

Flanged Tees and Crosses				
PART #				SIZE
TEES		CROSSES		
UNLINED	CEMENT-LINED	UNLINED	CEMENT-LINED	
20F-0202	W20F-0202-D	35F-0202	—	2"
20F-025025	W20F-025025-D	35F-025025	—	2½"
20F-0302	W20F-0302-D	—	—	3 × 2"
20F-03025	W20F-03025-D	—	—	3 × 2½"
20F-0303	W20F-0303-D	35F-0303	W35F-0303-D	3"
20F-0402	W20F-0402-D	—	—	4 × 2"
20F-04025	W20F-04025-D	—	—	4 × 2½"
20F-0403	W20F-0403-D	—	—	4 × 3"
20F-0404	W20F-0404-D	35F-0404	W35F-0404-D	4"
20F-0505	W20F-0505-D	—	—	5"
20F-0602	W20F-0602-D	—	—	6 × 2"
20F-0603	W20F-0603-D	—	—	6 × 3"
20F-0604	W20F-0604-D	35F-0604	W35F-0604-D	6 × 4"
20F-0605	W20F-0605-D	—	—	6 × 5"

Flanged Tees and Crosses (Cont.)				
PART #				SIZE
TEES		CROSSES		
UNLINED	CEMENT-LINED	UNLINED	CEMENT-LINED	
20F-0606	W20F-0606-D	35F-0606	W35F-0606-D	6"
20F-0803	W20F-0803-D	—	—	8 × 3"
20F-0804	W20F-0804-D	35F-0804	W35F-0804-D	8 × 4"
20F-0806	W20F-0806-D	35F-0806	W35F-0806-D	8 × 6"
20F-0808	W20F-0808-D	35F-0808	W35F-0808-D	8"
20F-1003	W20F-1003-D	—	—	10 × 3"
20F-1004	W20F-1004-D	—	—	10 × 4"
20F-1006	W20F-1006-D	35F-1006	W35F-1006-D	10 × 6"
20F-1008	W20F-1008-D	35F-1008	W35F-1008-D	10 × 8"
20F-1010	W20F-1010-D	35F-1010	W35F-1010-D	10"
20F-1204	W20F-1204-D	—	—	12 × 4"
20F-1206	W20F-1206-D	35F-1206	W35F-1206-D	12 × 6"
20F-1208	W20F-1208-D	35F-1208	W35F-1208-D	12 × 8"
20F-1210	W20F-1210-D	35F-1210	W35F-1210-D	12 × 10"
20F-1212	W20F-1212-D	35F-1212	W35F-1212-D	12"
20F-1406	W20F-1406-D	—	—	14 × 6"
20F-1408	W20F-1408-D	—	—	14 × 8"
20F-1410	W20F-1410-D	—	—	14 × 10"
20F-1412	W20F-1412-D	—	—	14 × 12"
20F-1414	W20F-1414-D	35F-1414	W35F-1414-D	14"
20F-1606	W20F-1606-D	—	—	16 × 6"
20F-1608	W20F-1608-D	—	—	16 × 8"
20F-1610	W20F-1610-D	—	—	16 × 10"
20F-1612	W20F-1612-D	—	—	16 × 12"
20F-1616	W20F-1616-D	35F-1616	W35F-1616-D	16"
20F-1818	W20F-1818-D	35F-1818	W35F-1818-D	18"
20F-2020	W20F-2020-D	35F-2020	W35F-2020-D	20"
20F-2424	W20F-2424-D	35F-2424	W35F-2424-D	24"

Flanged Reducing Tees		
PART #		SIZE
UNLINED	CEMENT-LINED	
26F-0434	W26F-0434-D	4 × 3 × 4"
26F-0644	W26F-0644-D	6 × 4 × 4"
26F-0646	W26F-0646-D	6 × 4 × 6"
26F-0848	W26F-0848-D	8 × 4 × 8"
26F-0864	W26F-0864-D	8 × 6 × 4"
26F-0866	W26F-0866-D	8 × 6 × 6"
26F-0868	W26F-0868-D	8 × 6 × 8"
26F-1088	W26F-1088-D	10 × 8 × 8"
26F-10810	W26F-10810-D	10 × 8 × 10"
26F-1288	W26F-1288-D	12 × 8 × 8"
26F-121010	W26F-121010-D	12 × 10 × 10"
26F-121012	W26F-121012-D	12 × 10 × 12"

Flanged Bullhead Tees		
PART #		SIZE
UNLINED	CEMENT-LINED	
27F-446	W27F-446-D	4 × 4 × 6"
27F-668	W27F-668-D	6 × 6 × 8"
27F-8810	W27F-8810-D	8 × 8 × 10"
27F-101012	W27F-101012-D	10 × 10 × 12"

Flanged Concentric and Eccentric Reducers				
PART #				SIZE
CONCENTRIC		ECCENTRIC		
UNLINED	CEMENT-LINED	UNLINED	CEMENT-LINED	
50F-0302	W50F-0302-D	51F-0302	W51F-0302-D	3 × 2"
50F-03025	W50F-03025-D	51F-03025	W51F-03025-D	3 × 2½"
50F-0402	W50F-0402-D	51F-0402	W51F-0402-D	4 × 2"
50F-04025	W50F-04025-D	51F-04025	W51F-04025-D	4 × 2½"
50F-0403	W50F-0403-D	51F-0403	W51F-0403-D	4 × 3"
50F-0602	W50F-0602-D	—	—	6 × 2"
50F-06025	W50F-06025-D	—	—	6 × 2½"
50F-0603	W50F-0603-D	51F-0603	W51F-0603-D	6 × 3"
50F-0604	W50F-0604-D	51F-0604	W51F-0604-D	6 × 4"
50F-0605	W50F-0605-D	51F-0605	W51F-0605-D	6 × 5"
50F-0803	W50F-0803-D	—	—	8 × 3"
50F-0804	W50F-0804-D	51F-0804	W51F-0804-D	8 × 4"
50F-0805	W50F-0805-D	51F-0805	W51F-0805-D	8 × 5"
50F-0806	W50F-0806-D	51F-0806	W51F-0806-D	8 × 6"
50F-1004	W50F-1004-D	51F-1004	W51F-1004-D	10 × 4"
50F-1006	W50F-1006-D	51F-1006	W51F-1006-D	10 × 6"
50F-1008	W50F-1008-D	51F-1008	W51F-1008-D	10 × 8"
50F-1204	W50F-1204-D	—	—	12 × 4"
50F-1206	W50F-1206-D	51F-1206	W51F-1206-D	12 × 6"
50F-1208	W50F-1208-D	51F-1208	W51F-1208-D	12 × 8"
50F-1210	W50F-1210-D	51F-1210	W51F-1210-D	12 × 10"
50F-1408	W50F-1408-D	51F-1408	W51F-1408-D	14 × 8"
50F-1410	W50F-1410-D	51F-1410	W51F-1410-D	14 × 10"
50F-1412	W50F-1412-D	51F-1412	W51F-1412-D	14 × 12"
50F-1608	W50F-1608-D	51F-1608	W51F-1608-D	16 × 8"
50F-1610	W50F-1610-D	51F-1610	W51F-1610-D	16 × 10"
50F-1612	W50F-1612-D	51F-1612	W51F-1612-D	16 × 12"
50F-1614	W50F-1614-D	51F-1614	W51F-1614-D	16 × 14"

Flanged Lateral Wyes		
PART #		SIZE
UNLINED	CEMENT-LINED	
30F-0303	W30F-0303-D	3"
30F-0404	W30F-0404-D	4"
30F-0604	W30F-0604-D	6 × 4"
30F-0606	W30F-0606-D	6"
30F-0806	W30F-0806-D	8 × 6"
30F-0808	W30F-0808-D	8"
30F-1006	W30F-1006-D	10 × 6"
30F-1010	W30F-1010-D	10"
30F-1206	W30F-1206-D	12 × 6"
30F-1208	W30F-1208-D	12 × 8"
30F-1212	W30F-1212-D	12"

Flanged True Wyes		
PART #		SIZE
UNLINED	CEMENT-LINED	
32F-0404	W32F-0404-D	4"
32F-0606	W32F-0606-D	6"
32F-0808	W32F-0808-D	8"
—	W32F-1010-D	10"
—	W32F-1212-D	12"

Flange Accessory Packs

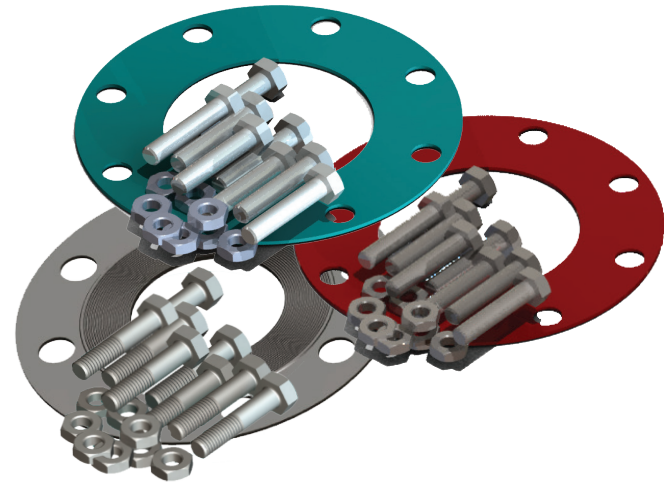

DESCRIPTION

2"-48" Flange Accessory Packs

ADDITIONAL INFO

- Available gaskets: Red Rubber, Non-Asbestos, and Seal-Tite. Other gaskets and sizes available upon request.
- Reference standard: ANSI B16.1 Class 125
- Available hardware: Zinc plated, 304 Stainless Steel, and 316 Stainless Steel.
- Reference standard: Hex head bolts to ANSI B18.2.1 with ANSI B18.2.2 hex head nuts. Bolts to ANSI B1.1 unified inch screw threads, Class 2A external & 2B internal.
- Material standard: ASTM A307 carbon steel—Zinc plated ASTM B633, Stainless steel 304 & 316 bolts. ASTM F593. Stainless steel 304 & 316 nuts, ASTM F594.

Non-Asbestos Flange Accessory Packs

FLANGE SIZE	FULL FACE				RING TYPE			
	ZINC PLATED	304 SS	316 SS	ZINC CLASS 250	ZINC PLATED	304 SS	316 SS	ZINC CLASS 250
1"	FNP-010Z	FNP-010-304	FNP-010-316	FNP-010-250#	RNP-010Z	RNP-010-304	RNP-010-316	RNP-010-250#
1¼"	FNP-012Z	FNP-012-304	FNP-012-316	FNP-012-250#	RNP-012Z	RNP-012-304	RNP-012-316	RNP-012-250#
1½"	FNP-015Z	FNP-015-304	FNP-015-316	FNP-015-250#	RNP-015Z	RNP-015-304	RNP-015-316	RNP-015-250#
2"	FNP-020Z	FNP-020-304	FNP-020-316	FNP-020-250#	RNP-020Z	RNP-020-304	RNP-020-316	RNP-020-250#
2½"	FNP-025Z	FNP-025-304	FNP-025-316	FNP-025-250#	RNP-025Z	RNP-025-304	RNP-025-316	RNP-025-250#
3"	FNP-030Z	FNP-030-304	FNP-030-316	FNP-030-250#	RNP-030Z	RNP-030-304	RNP-030-316	RNP-030-250#
4"	FNP-040Z	FNP-040-304	FNP-040-316	FNP-040-250#	RNP-040Z	RNP-040-304	RNP-040-316	RNP-040-250#
5"	FNP-050Z	FNP-050-304	FNP-050-316	FNP-050-250#	RNP-050Z	RNP-050-304	RNP-050-316	RNP-050-250#
6"	FNP-060Z	FNP-060-304	FNP-060-316	FNP-060-250#	RNP-060Z	RNP-060-304	RNP-060-316	RNP-060-250#
8"	FNP-080Z	FNP-080-304	FNP-080-316	FNP-080-250#	RNP-080Z	RNP-080-304	RNP-080-316	RNP-080-250#
10"	FNP-100Z	FNP-100-304	FNP-100-316	FNP-100-250#	RNP-100Z	RNP-100-304	RNP-100-316	RNP-100-250#
12"	FNP-120Z	FNP-120-304	FNP-120-316	FNP-120-250#	RNP-120Z	RNP-120-304	RNP-120-316	RNP-120-250#
14"	FNP-140Z	FNP-140-304	FNP-140-316	FNP-140-250#	RNP-140Z	RNP-140-304	RNP-140-316	RNP-140-250#
16"	FNP-160Z	FNP-160-304	FNP-160-316	FNP-160-250#	RNP-160Z	RNP-160-304	RNP-160-316	RNP-160-250#
18"	FNP-180Z	FNP-180-304	FNP-180-316	FNP-180-250#	RNP-180Z	RNP-180-304	RNP-180-316	RNP-180-250#
20"	FNP-200Z	FNP-200-304	FNP-200-316	FNP-200-250#	RNP-200Z	RNP-200-304	RNP-200-316	RNP-200-250#
24"	FNP-240Z	FNP-240-304	FNP-240-316	FNP-240-250#	RNP-240Z	RNP-240-304	RNP-240-316	RNP-240-250#

Red Rubber Flange Accessory Packs

FLANGE SIZE	FULL FACE				RING TYPE			
	ZINC PLATED	304 SS	316 SS	ZINC CLASS 250	ZINC PLATED	304 SS	316 SS	ZINC CLASS 250
1"	FRP-010Z	FRP-010-304	FRP-010-316	FRP-010-250#	RRP-010Z	RRP-010-304	RRP-010-316	RRP-010-250#
1¼"	FRP-012Z	FRP-012-304	FRP-012-316	FRP-012-250#	RRP-012Z	RRP-012-304	RRP-012-316	RRP-012-250#
1½"	FRP-015Z	FRP-015-304	FRP-015-316	FRP-015-250#	RRP-015Z	RRP-015-304	RRP-015-316	RRP-015-250#
2"	FRP-020Z	FRP-020-304	FRP-020-316	FRP-020-250#	RRP-020Z	RRP-020-304	RRP-020-316	RRP-020-250#
2½"	FRP-025Z	FRP-025-304	FRP-025-316	FRP-025-250#	RRP-025Z	RRP-025-304	RRP-025-316	RRP-025-250#
3"	FRP-030Z	FRP-030-304	FRP-030-316	FRP-030-250#	RRP-030Z	RRP-030-304	RRP-030-316	RRP-030-250#
4"	FRP-040Z	FRP-040-304	FRP-040-316	FRP-040-250#	RRP-040Z	RRP-040-304	RRP-040-316	RRP-040-250#
5"	FRP-050Z	FRP-050-304	FRP-050-316	FRP-050-250#	RRP-050Z	RRP-050-304	RRP-050-316	RRP-050-250#
6"	FRP-060Z	FRP-060-304	FRP-060-316	FRP-060-250#	RRP-060Z	RRP-060-304	RRP-060-316	RRP-060-250#
8"	FRP-080Z	FRP-080-304	FRP-080-316	FRP-080-250#	RRP-080Z	RRP-080-304	RRP-080-316	RRP-080-250#
10"	FRP-100Z	FRP-100-304	FRP-100-316	FRP-100-250#	RRP-100Z	RRP-100-304	RRP-100-316	RRP-100-250#
12"	FRP-120Z	FRP-120-304	FRP-120-316	FRP-120-250#	RRP-120Z	RRP-120-304	RRP-120-316	RRP-120-250#
14"	FRP-140Z	FRP-140-304	FRP-140-316	FRP-140-250#	RRP-140Z	RRP-140-304	RRP-140-316	RRP-140-250#
16"	FRP-160Z	FRP-160-304	FRP-160-316	FRP-160-250#	RRP-160Z	RRP-160-304	RRP-160-316	RRP-160-250#
18"	FRP-180Z	FRP-180-304	FRP-180-316	FRP-180-250#	RRP-180Z	RRP-180-304	RRP-180-316	RRP-180-250#
20"	FRP-200Z	FRP-200-304	FRP-200-316	FRP-200-250#	RRP-200Z	RRP-200-304	RRP-200-316	RRP-200-250#
24"	FRP-240Z	FRP-240-304	FRP-240-316	FRP-240-250#	RRP-240Z	RRP-240-304	RRP-240-316	RRP-240-250#
30"	FRP-300Z	FRP-300-304	FRP-300-316	FRP-300-250#	RRP-300Z	RRP-300-304	RRP-300-316	RRP-300-250#
36"	FRP-360Z	FRP-360-304	FRP-360-316	FRP-360-250#	RRP-360Z	RRP-360-304	RRP-360-316	RRP-360-250#
42"	FRP-420Z	FRP-420-304	FRP-420-316	FRP-420-250#	RRP-420Z	RRP-420-304	RRP-420-316	RRP-420-250#
48"	FRP-480Z	FRP-480-304	FRP-480-316	FRP-480-250#	RRP-480Z	RRP-480-304	RRP-480-316	RRP-480-250#

Seal-Tite Flange Accessory Packs

FLANGE SIZE	FULL FACE				RING TYPE			
	ZINC PLATED	304 SS	316 SS	ZINC CLASS 250	ZINC PLATED	304 SS	316 SS	ZINC CLASS 250
1"	FBP-010Z	FBP-010-304	FBP-010-316	FBP-010-250#	RBP-010Z	RBP-010-304	RBP-010-316	RBP-010-250#
1¼"	FBP-012Z	FBP-012-304	FBP-012-316	FBP-012-250#	RBP-012Z	RBP-012-304	RBP-012-316	RBP-012-250#
1½"	FBP-015Z	FBP-015-304	FBP-015-316	FBP-015-250#	RBP-015Z	RBP-015-304	RBP-015-316	RBP-015-250#
2"	FBP-020Z	FBP-020-304	FBP-020-316	FBP-020-250#	RBP-020Z	RBP-020-304	RBP-020-316	RBP-020-250#
2½"	FBP-025Z	FBP-025-304	FBP-025-316	FBP-025-250#	RBP-025Z	RBP-025-304	RBP-025-316	RBP-025-250#
3"	FBP-030Z	FBP-030-304	FBP-030-316	FBP-030-250#	RBP-030Z	RBP-030-304	RBP-030-316	RBP-030-250#
4"	FBP-040Z	FBP-040-304	FBP-040-316	FBP-040-250#	RBP-040Z	RBP-040-304	RBP-040-316	RBP-040-250#
5"	FBP-050Z	FBP-050-304	FBP-050-316	FBP-050-250#	RBP-050Z	RBP-050-304	RBP-050-316	RBP-050-250#
6"	FBP-060Z	FBP-060-304	FBP-060-316	FBP-060-250#	RBP-060Z	RBP-060-304	RBP-060-316	RBP-060-250#
8"	FBP-080Z	FBP-080-304	FBP-080-316	FBP-080-250#	RBP-080Z	RBP-080-304	RBP-080-316	RBP-080-250#
10"	FBP-100Z	FBP-100-304	FBP-100-316	FBP-100-250#	RBP-100Z	RBP-100-304	RBP-100-316	RBP-100-250#
12"	FBP-120Z	FBP-120-304	FBP-120-316	FBP-120-250#	RBP-120Z	RBP-120-304	RBP-120-316	RBP-120-250#
14"	FBP-140Z	FBP-140-304	FBP-140-316	FBP-140-250#	RBP-140Z	RBP-140-304	RBP-140-316	RBP-140-250#
16"	FBP-160Z	FBP-160-304	FBP-160-316	FBP-160-250#	RBP-160Z	RBP-160-304	RBP-160-316	RBP-160-250#
18"	FBP-180Z	FBP-180-304	FBP-180-316	FBP-180-250#	RBP-180Z	RBP-180-304	RBP-180-316	RBP-180-250#
20"	FBP-200Z	FBP-200-304	FBP-200-316	FBP-200-250#	RBP-200Z	RBP-200-304	RBP-200-316	RBP-200-250#
24"	FBP-240Z	FBP-240-304	FBP-240-316	FBP-240-250#	RBP-240Z	RBP-240-304	RBP-240-316	RBP-240-250#

Bolt Packs



DESCRIPTION

1"-48" Bolt Packs

ADDITIONAL INFO

- Available hardware: Zinc plated, 304 Stainless Steel, and 316 Stainless Steel.
- Reference standard: Hex head bolts to ANSI B18.2.1 with ANSI B18.2.2 hex head nuts. Bolts to ANSI B1.1 unified inch screw threads, Class 2A external & 2B internal.
- Material standard: ASTM A307 carbon steel– Zinc plated ASTM B633, Stainless steel 304 & 316 bolts. ASTM F593.
- Stainless steel 304 & 316 nuts, ASTM F594.

Bolt Packs

FLANGE SIZE	ZINC PLATED	304 STAINLESS STEEL	316 STAINLESS STEEL
1"	FBZ015	–	–
1¼"	FBZ015	–	–
1½"	FBZ015	–	–
2"	FBZ03	FBS03-304	FBS03-316
2½"	FBZ03	FBS03-304	FBS03-316
3"	FBZ03	FBS03-304	FBS03-316
4"	FBZ04	FBS04-304	FBS04-316
5"	FBZ08	FBS08-304	FBS08-316
6"	FBZ08	FBS08-304	FBS08-316
8"	FBZ08	FBS08-304	FBS08-316
10"	FBZ12	FBS12-304	FBS12-316
12"	FBZ12	FBS12-304	FBS12-316
14"	FBZ14	FBS14-304	FBS14-316
16"	FBZ16	FBS16-304	FBS16-316
18"	FBZ18	FBS18-304	FBS18-316
20"	FBZ20	FBS20-304	FBS20-316
24"	FBZ24	FBS24-304	FBS24-316
30"	FBZ30	FBS30-304	FBS30-316
36"	FBZ36	FBS36-304	FBS36-316
42"	FBZ42	–	–
48"	FBZ48	–	–

Stud Bolt & Nut Packs

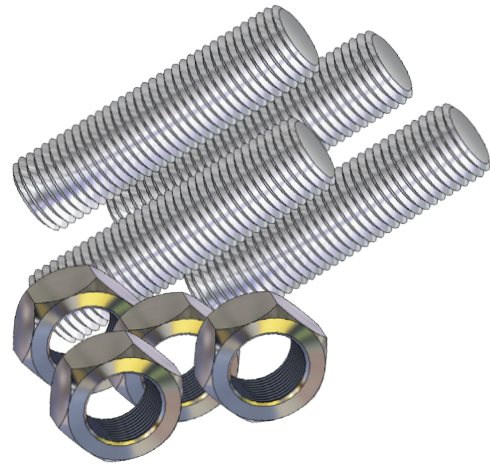

DESCRIPTION

2"-48" Stud Bolt & Nut Packs

ADDITIONAL INFO

- Available hardware: Zinc plated, 304 Stainless Steel, and 316 Stainless Steel.
- Reference standard: Stud bolts to ANSI B18.2.1 with ANSI B18.2.2 hex head nuts. Studs to ANSI B1.1 unified inch screw threads, Class 2A external and 2B internal.
- Material standard: ASTM A307 carbon steel– Zinc plated ASTM B633, Stainless steel 304 & 316 bolts. ASTM F593. Stainless steel 304 & 316 nuts, ASTM F594.

Stud Bolt & Nut Packs

FLANGE SIZE	ZINC PLATED	304 STAINLESS STEEL	316 STAINLESS STEEL
2"	FSB03	FSB03-304	FSB03-316
2½"	FSB03	FSB03-304	FSB03-316
3"	FSB03	FSB03-304	FSB03-316
4"	FSB04	FSB04-304	FSB04-316
5"	FSB08	FSB08-304	FSB08-316
6"	FSB08	FSB08-304	FSB08-316
8"	FSB08	FSB08-304	FSB08-316
10"	FSB12	FSB12-304	FSB12-316
12"	FSB12	FSB12-304	FSB12-316
14"	FSB14	FSB14-304	FSB14-316
16"	FSB16	FSB16-304	FSB16-316
18"	FSB18	FSB18-304	FSB18-316
20"	FSB20	FSB20-304	FSB20-316
24"	FSB24	FSB24-304	FSB24-316
30"	FSB30	FSB30-304	FSB30-316
36"	FSB36	FSB36-304	FSB36-316
42"	FSB42	FSB42-304	FSB42-316
48"	FSB48	FSB48-304	FSB48-316

Flange Gaskets

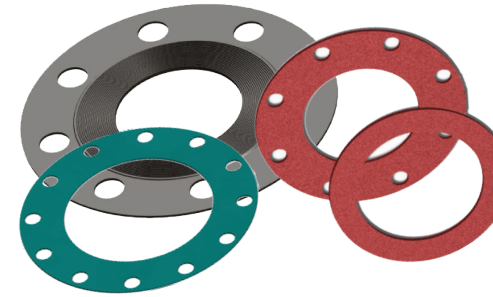

DESCRIPTION

1"-48" Flange Gaskets

ADDITIONAL INFO

- Available gaskets: Red Rubber, Non-Asbestos, and Seal-Tite. Other gaskets and sizes available upon request.
- Reference standard: ANSI B16.1 Class 125

Flange Gaskets

FLANGE SIZE	FULL FACE			RING TYPE		
	SEAL-TITE	RED RUBBER	NON-ASBESTOS	SEAL-TITE	RED RUBBER	NON-ASBESTOS
1"	–	FFRG-010	FFNG-010	–	RRG-010	RNG-010
1¼"	–	FFRG-012	FFNG-012	–	RRG-012	RNG-012
1½"	–	FFRG-015	FFNG-015	–	RRG-015	RNG-015
2"	FFG-050-150	FFRG-020	FFNG-020	RG-050-100	RRG-020	RNG-020
2½"	FFG-065-175	FFRG-025	FFNG-025	RG-065-120	RRG-025	RNG-025
3"	FFG-080-188	FFRG-030	FFNG-030	RG-080-132	RRG-030	RNG-030
4"	FFG-100-210	FFRG-040	FFNG-040	RG-100-162	RRG-040	RNG-040
5"	FFG-125-250	FFRG-050	FFNG-050	RG-125-194	RRG-050	RNG-050
6"	FFG-150-275	FFRG-060	FFNG-060	RG-150-218	RRG-060	RNG-060
8"	FFG-200-340	FFRG-080	FFNG-080	RG-200-272	RRG-080	RNG-080
10"	FFG-250-400	FFRG-100	FFNG-100	RG-250-328	RRG-100	RNG-100
12"	FFG-300-475	FFRG-120	FFNG-120	RG-300-378	RRG-120	RNG-120
14"	FFG-350-525	FFRG-140	FFNG-140	RG-350-445	RRG-140	RNG-140
16"	FFG-400-588	FFRG-160	FFNG-160	RG-400-510	RRG-160	RNG-160
18"	FFG-450-625	FFRG-180	FFNG-180	RG-450-542	RRG-180	RNG-180
20"	FFG-500-688	FFRG-200	FFNG-200	RG-500-606	RRG-200	RNG-200
24"	FFG-600-800	FFRG-240	FFNG-240	RG-600-717	RRG-240	RNG-240
30"	–	FFRG-300	–	–	–	–
36"	–	FFRG-360	–	–	–	–
42"	–	FFRG-420	–	–	–	–
48"	–	FFRG-480	–	–	–	–

Flange Converter–Series 840



DESCRIPTION

This product allows the conversion of existing Class 250/300 flanged pumps, valves, etc. to a Class 125/150 flange system without the use of fabricated transition spools.

ADDITIONAL INFO

- Class 125/150 & Class 250/300
- Sizes range from 3"~12".
- Material: Ductile Iron ASTM A536, Grade 65-45-12
- Shipped with accessories.

Flange Converter–Series 840

FLANGE SIZE	PART NUMBER	PART NUMBER WITH ACCESSORIES
3"	840-130	840-130ACC
4"	840-140	840-140ACC
5"	840-150	840-150ACC
6"	840-160	840-160ACC
8"	840-180	840-180ACC
10"	840-200	840-200ACC
12"	840-220	840-220ACC

Compact Flange Reducer–Series 740 (Type A) & 790 (Type B)



DESCRIPTION

These reducers will mate with Class 125/150 flanges, allowing a reduction of flange sizes in a relatively small space. Sizes range from 2" x 1-1/2" to 16" x 14".

ADDITIONAL INFO

- Material: Ductile Iron ASTM A536, Grade 65-45-12
- Mates with ANSI B16.1 Class 125/150 flange drilling
- Shipped with accessories.

Compact Flange Reducer–Series 740 & 790

FLANGE SIZE	PART NUMBER	PART NUMBER WITH ACCESSORIES
2 x 1½"	740-110-100	740-110-100ACC
2½ x 1½"	740-120-100	740-120-100ACC

Compact Flange Reducer–Series 740 & 790

FLANGE SIZE	PART NUMBER	PART NUMBER WITH ACCESSORIES
2½ x 2"	740-120-110	740-120-110ACC
3 x 1½"	740-130-100	740-130-100ACC
3 x 2"	740-130-110	740-130-110ACC
3 x 2½"	740-130-120	740-130-120ACC
4 x 2"	740-140-110	740-140-110ACC
4 x 2½"	740-140-120	740-140-120ACC
4 x 3"	740-140-130	740-140-130ACC
6 x 2½"	790-160-120	790-160-120ACC
6 x 3"	790-160-130	790-160-130ACC
6 x 4"	740-160-140	740-160-140ACC
6 x 5"	740-160-150	740-160-150ACC
8 x 4"	790-180-140	790-180-140ACC
8 x 5"	740-180-150	740-180-150ACC
8 x 6"	740-180-160	740-180-160ACC
10 x 2"	790-200-110	790-200-110ACC
10 x 4"	790-200-140	790-200-140ACC
10 x 5"	790-200-150	790-200-150ACC
10 x 6"	740-200-160	740-200-160ACC
10 x 8"	740-200-180	740-200-180ACC
12 x 4"	790-220-140	790-220-140ACC
12 x 6"	790-220-160	790-220-160ACC
12 x 8"	740-220-180	740-220-180ACC
12 x 10"	740-220-200	740-220-200ACC
14 x 6"	790-240-160	790-240-160ACC
14 x 8"	790-240-180	790-240-180ACC
14 x 10"	740-240-200	740-240-200ACC
14 x 12"	740-240-220	740-240-220ACC
16 x 6"	790-260-160	790-260-160ACC
16 x 8"	790-260-180	790-260-180ACC
16 x 10"	790-260-200	790-260-200ACC
16 x 12"	740-260-220	740-260-220ACC
16 x 14"	740-260-240	740-260-240ACC
18 x 12"	790-280-220	790-280-220ACC
20 x 12"	790-300-220	790-300-220ACC

Grooved x Flange Adapter–Series GFA



DESCRIPTION

These adapters allow the connection between grooved end products and Class 125/150 Flange Ends products.

ADDITIONAL INFO

- Flanges are made of high strength ductile iron.
- Available in sizes 2"~12".

Grooved x Flange Adapter–Series #GFA

FLANGE SIZE	PART NUMBER	WITH ACCESORIES
2"	GFA-201	GFA-201ACC
2½"	GFA-202	GFA-202ACC
3"	GFA-203	GFA-203ACC
4"	GFA-204	GFA-204ACC
6"	GFA-206	GFA-206ACC
8"	GFA-208	GFA-208ACC
10"	GFA-210	GFA-210ACC
12"	GFA-212	GFA-212ACC

Explore More Solutions Across Our Brands

At PUPCO, we provide more than just products—we offer solutions. With a diverse range of inventory spanning electrical infrastructure, datacom and wireless, PVF, waterworks, and fire protection, our family of brands has what you need to tackle any project.

Why Choose Us?

We simplify your supply needs by offering fast, reliable shipping, flexible and customizable programs tailored to your business, and dedicated, personalized service every step of the way. By consolidating orders across our trusted family of brands, you reduce complexity, streamline procurement, and gain peace of mind knowing you're backed by a partner committed to efficiency, consistency, and your long-term success.



Discover how our brands can help you save time, streamline processes, and get the job done right.
Expand your product mix today!





www.UnitedWaterProducts.com | (401) 250-3800