

# COMPACT FLANGE REDUCER

## Class 125/150 Flanges

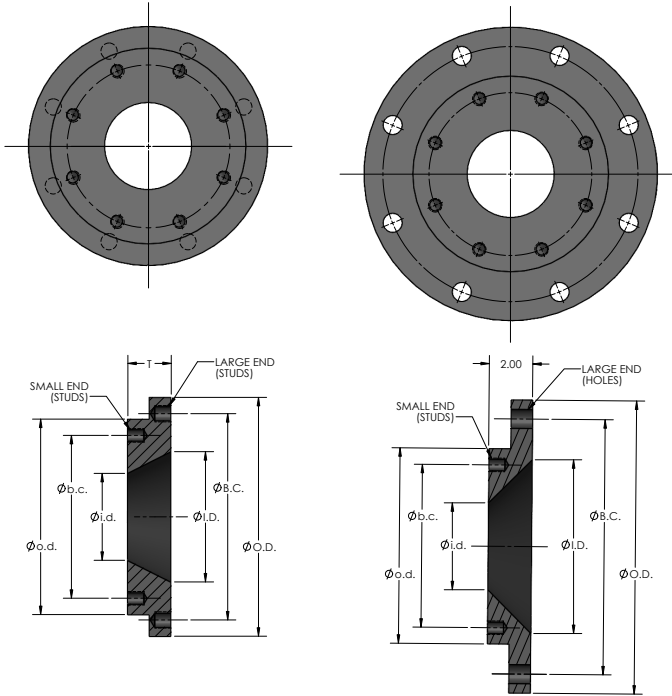

### DESCRIPTION

- Material: Ductile Iron ASTM A536 or ASTM A36 Steel
- Mates with ANSI Class 125/150 flange drilling

Design, dimensions, and materials are subject to change without notice.

### Compact Flange Reducer

FLANGE SIZE	PART NUMBER	LARGE END			SMALL END			T	Type	LARGE END STUDS		SMALL END STUDS	
		I.D.	O.D.	B.C.	i.d.	o.d.	b.c.			Qty.	Size	Qty.	Size
2 × 1½	740-110-100	2.00	6.00	4.75	1.50	5.00	3.88	1.50	A	4	5/8 × 3	4	1/2 × 2
2½ × 1½	740-120-100	2.50	7.00	5.50	1.50	5.00	3.88	1.50	A	4	5/8 × 3	4	1/2 × 2
2½ × 2	740-120-110	2.50	7.00	5.50	2.00	6.00	4.75	1.50	A	4	5/8 × 3	4	5/8 × 3
3 × 1½	740-130-100	3.00	7.50	6.00	1.50	5.00	3.88	1.50	A	4	5/8 × 3	4	1/2 × 2
3 × 2	740-130-110	3.00	7.50	6.00	2.00	6.00	4.75	1.50	A	4	5/8 × 3	4	5/8 × 3
3 × 2½	740-130-120	3.00	7.50	6.00	2.50	7.00	5.50	1.50	A	4	5/8 × 3	4	5/8 × 3
4 × 2	740-140-110	4.00	9.00	7.50	2.00	6.00	4.75	1.50	A	8	5/8 × 3	4	5/8 × 3
4 × 2½	740-140-120	4.00	9.00	7.50	2.50	7.00	5.50	1.50	A	8	5/8 × 3	4	5/8 × 3
4 × 3	740-140-130	4.00	9.00	7.50	3.00	7.50	6.00	1.50	A	8	5/8 × 3	4	5/8 × 3
6 × 2½	790-160-120	6.00	11.00	9.50	2.50	7.00	5.50	1.50	B	—	—	4	5/8 × 3
6 × 3	790-160-130	6.00	11.00	9.50	3.00	7.50	6.00	1.50	B	—	—	4	5/8 × 3
6 × 4	740-160-140	6.00	11.00	9.50	4.00	9.00	7.50	2.00	A	8	3/4 × 3½	8	5/8 × 3
6 × 5	740-160-150	6.00	11.00	9.50	5.00	10.00	8.50	2.00	A	8	3/4 × 3½	8	3/4 × 3½

# COMPACT FLANGE REDUCER | Class 125/150 Flanges

Compact Flange Reducer													
FLANGE SIZE	PART NUMBER	LARGE END			SMALL END			T	Type	LARGE END STUDS		SMALL END STUDS	
		I.D.	O.D.	B.C.	i.d.	o.d.	b.c.			Qty.	Size	Qty.	Size
8 x 4	790-180-140	8.00	13.50	11.75	4.00	9.00	7.50	2.00	B	—	—	8	5/8 x 3
8 x 5	740-180-150	8.00	13.50	11.75	5.00	10.00	8.50	2.00	A	8	3/4 x 3 1/2	8	3/4 x 3 1/2
8 x 6	740-180-160	8.00	13.50	11.75	6.00	11.00	9.50	2.00	A	8	3/4 x 3 1/2	8	3/4 x 3 1/2
10 x 2	790-200-110	10.00	16.00	14.25	2.00	6.00	4.75	1.50	B	—	—	4	5/8 x 3
10 x 4	790-200-140	10.00	16.00	14.25	4.00	9.00	7.50	2.00	B	—	—	8	5/8 x 3
10 x 5	790-200-150	10.00	16.00	14.25	5.00	10.00	8.50	2.00	B	—	—	8	3/4 x 3 1/2
10 x 6	740-200-160	10.00	16.00	14.25	6.00	11.00	9.50	2.00	A	12	7/8 x 4	8	3/4 x 3 1/2
10 x 8	740-200-180	10.00	16.00	14.25	8.00	13.50	11.75	2.00	A	12	7/8 x 4	8	3/4 x 3 1/2
12 x 4	790-220-140	12.00	19.00	17.00	4.00	9.00	7.50	2.00	B	—	—	8	5/8 x 3
12 x 6	790-220-160	12.00	19.00	17.00	6.00	11.00	9.50	2.00	B	—	—	8	3/4 x 3 1/2
12 x 8	740-220-180	12.00	19.00	17.00	8.00	13.50	11.75	2.00	A	12	7/8 x 4	8	3/4 x 3 1/2
12 x 10	740-220-200	12.00	19.00	17.00	10.00	16.00	14.25	2.00	A	12	7/8 x 4	12	7/8 x 4
14 x 6	790-240-160	14.00	21.00	18.75	6.00	11.00	9.50	2.50	B	—	—	8	3/4 x 3 1/2
14 x 8	790-240-180	14.00	21.00	18.75	8.00	13.50	11.75	2.50	B	—	—	8	3/4 x 3 1/2
14 x 10	740-240-200	14.00	21.00	18.75	10.00	16.00	14.25	2.50	A	12	1 x 4 1/2	12	7/8 x 4
14 x 12	740-240-220	14.00	21.00	18.75	12.00	19.00	17.00	2.50	A	12	1 x 4 1/2	12	7/8 x 4
16 x 6	790-260-160	16.00	23.50	21.25	6.00	11.00	9.50	2.50	B	—	—	8	3/4 x 3 1/2
16 x 8	790-260-180	16.00	23.50	21.25	8.00	13.50	11.75	2.50	B	—	—	8	3/4 x 3 1/2
16 x 10	790-260-200	16.00	23.50	21.25	10.00	16.00	14.25	2.50	B	—	—	12	7/8 x 4
16 x 12	740-260-220	16.00	23.50	21.25	12.00	19.00	17.00	2.50	A	16	1 x 4 1/2	12	7/8 x 4
16 x 14	740-260-240	16.00	23.50	21.25	14.00	21.00	18.75	2.50	A	16	1 x 4 1/2	12	1 x 4 1/2
18 x 12	790-280-220	18.00	25.00	22.75	12.00	19.00	17.00	2.50	B	—	—	12	7/8 x 4
20 x 12	790-300-220	20.00	27.50	25.00	12.00	19.00	17.00	2.50	B	—	—	12	7/8 x 4